



Shades of... MecVel!

A complete range of inline electric
linear actuators developed to fit
perfectly the handlings required in
the field of home automation and
shading systems



Since 1987 MecVel manufactures electric linear actuators, electromechanical devices able to transform the rotatory motion of a motor into a linear movement, allowing to lift, position, push, pull each load even of 20 tons (200.000 N). One of the main plus highlighting MecVel proposal in the market is definitely the customization service provided to customers, which gives the possibility to tailor each linear actuator according to the application needs, in terms of force, power, speed and stroke required. The inline range developed by MecVel, where the power supply is placed immediately afterwards the mechanical part, remaining along the same axis, has the feature to preserve its efficiency together with small overall dimensions, offering products of "design" and high performance, suitable for a wide spectrum of applications, such as home automation and shading systems.

In fact, looking at minimal environmental impact and energy saving, these systems are more and more required, and for this reason MecVel proposes ad hoc solutions for the linear movements needed by these applications, with electromechanical and eco-friendly devices, equipped with ball screws for a further increase in terms of performance and a wide selection of optional dedicated to keep a constant control along the stroke of the linear actuator and preserve it from atmospheric agents, as it can be also placed directly outside.

Without any restriction in terms of the material chosen for the shelter, linear actuators can be used with windows, panels, umbrella structures of different dimensions and architectures, to allow both horizontal and vertical movements, to automate the opening/closing of these systems, in single units or group solutions, depending on the size of the area to be protected from atmospheric agents. Moreover thanks to customized front and rear ends, MecVel provides optimal fixing points for linear actuators to the existing structures.

Then in terms of home automation, the user is free to set the cycle and degree of shelter desired, leaving linear actuators the task to execute the request. This kind of handling avoids also unnecessary heating or cooling, limiting cold, rain and penetration of UV rays, and that's why often these systems are chosen also by buildings in the medical field, as together with energy saving there is a significant increase in climatic comfort.

With L series, designed to manage medium-low loads (up to 5.000 N) with quite high speed (up to 100 mm/s), and EC series, able to handle loads up to 50.000 N with speed from 230 to 15 mm/s depending on the load, MecVel can supply a wide range of applications with innovative solutions that meet both aesthetic and efficiency requirements.

L02 and L03 linear actuators

Load: 2.000 - 5.000 N

Speed: 100 - 30 mm/s

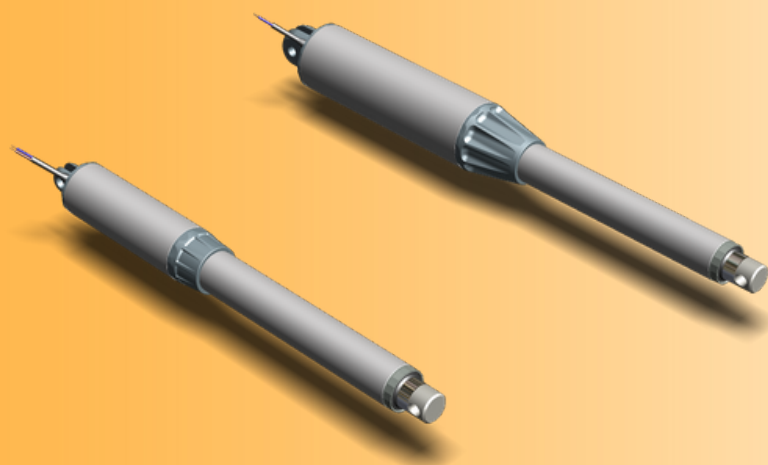

EC linear actuators

Load: 5.000 - 50.000 N

Speed: 230 - 15 mm/s

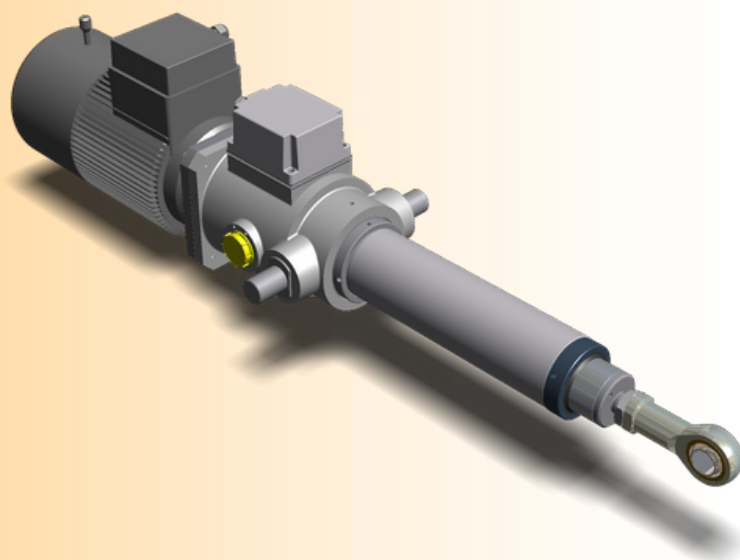

For more information or to set up your product contact us at:

MecVel Srl - Via Due Portoni 23, Bologna, Italy - 051 4143711 - info@mecvel.com - marketing@mecvel.com - www.mecvel.com